

Apollo® 70-100 Series Bronze Ball Valve

Threaded, 600 psig WOG, Cold Non-Shock. 150 psig Saturated Steam.
Vacuum Service to 29 inches Hg.
Federal Specification: WW-V-35C, Type: II, Composition: BZ, Style: 3.

FEATURES

- Chromium plated ball
- RPTFE seats and stuffing box ring
- Blow-out-proof stem design
- Adjustable packing gland

STANDARD MATERIAL LIST

1. Lever and grip	Steel, zinc plated w/vinyl	7. Gland nut	B16
2. Stem packing	RPTFE	8. Stem	B16
3. Stem bearing	RPTFE	9. Lever nut	Steel, zinc plated
4. Ball	B16, chrome plated	10. Body seal (1-1/4" to 3")	PTFE
5. Seat (2)	RPTFE	11. Body	B584-C84400
6. Retainer	B16 (1/4" to 1") B584-C84400 (1-1/4" to 3")		

VARIATIONS AVAILABLE:

- 70-120 Series (Adjustable Stop Lever)
- 70-140 Series (316 SS Ball & Stem)
- 70-150 Series (Balancing Stop)
- 70-190 Series (Locked Retainer)

OPTIONS AVAILABLE:

(SUFFIX)	OPTION	SIZES
-02-	Static Grounded	1/4" to 3"
-03-	1-1/4" Stem Extension	1/4" to 3"
-04-	2-1/4" Stem Extension	1/4" to 3"
-05-	Plain Ball	1/4" to 3"
-07-	Tee Handle	1/4" to 2"
-08-	90° Reversed Stem	1/4" to 3"
-10-	SS Lever & Nut	1/4" to 3"
-14-	Vented Ball (see page J-2)	1/4" to 3"
-15-	Round Handle	1/4" to 2"
-16-	Vertical Chain Lever	3/4" to 2"
-17-	Rough Chrome Plating	1/4" to 3"
-21-	UHMWPE Seats (Non-PTFE)	1/4" to 3"
-24-	Graphite Stem Packing	1/4" to 3"
-27-	Latch Lock Lever	1/4" to 3"
-30-	CamLock Handle	1/4" to 2"
-32-	SS Tee Handle & Nut	1/4" to 2"
-35-	PTFE Trim	1/4" to 3"
-39-	SS Latch Lock Wheel Handle	1/4" to 2"
-40-	Cyl-Loc	1/4" to 2"
-41-	Auto Drain (See page J-8)	1/4" to 2"
-45-	Less Lever & Nut	1/4" to 3"
-46-	Latch Lock Lever - Lock Close Only	1/4" to 3"
-47-	SS Latch-Lock Oval Handle	1/4" to 1"
-48-	SS Oval Handle	1/4" to 2"
-49-	Assembled Dry	1/4" to 3"
-50-	2-1/4" Locking Stem Extension	1/4" to 3"
-56-	Multifill Seats	1/4" to 3"
-57-	Cleaned for Gaseous Oxygen	1/4" to 3"
-58-	Horizontal Chain Lever	3/4" to 2"
-60-	Static Grounded Ball & Stem	1/4" to 3"
-63-	Threaded x Solder	3/8" to 3"
-64-	250 Lb. Steam Trim	1/4" to 3"
-P01-	BSPP (Parallel) Thread Connection	1/4" to 3"
-T01-	BSPT (Tapered) Thread Connection	1/4" to 3"

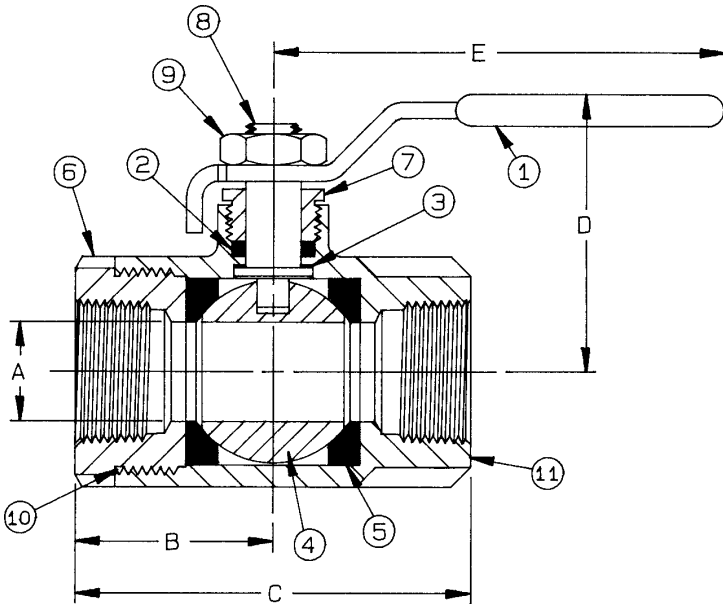

BRONZE BALL VALVE

NUMBER	SIZE	A	B	C	D	E	Wt.
70-101-01	1/4"	.37	1.03	2.06	1.75	3.87	.60
70-102-01	3/8"	.37	1.03	2.06	1.75	3.87	.56
70-103-01	1/2"	.50	1.12	2.25	1.75	3.87	.63
70-104-01	3/4"	.68	1.50	3.00	2.12	4.87	1.39
70-105-01	1"	.87	1.68	3.37	2.25	4.87	1.72
70-106-01	1-1/4"	1.00	2.00	4.00	2.62	5.50	3.26
70-107-01	1-1/2"	1.25	2.18	4.37	3.06	8.00	4.61
70-108-01	2"	1.50	2.34	4.68	3.25	8.00	6.06
70-109-01A	2-1/2"	2.00	3.12	6.25	3.72	8.00	17.25
70-100-01	3"	2.50	3.37	6.75	4.12	8.00	18.60

**For Pressure/Temperature Ratings,
Refer to Page N-10, Graph No. 4**